

Equipment		
Width	Depth	Height
755	75	755
Internal Dimensions		
Width	Depth	Height
755	75	755
Weight	Approx. 8 Kg	
Wall Thickness		7mm

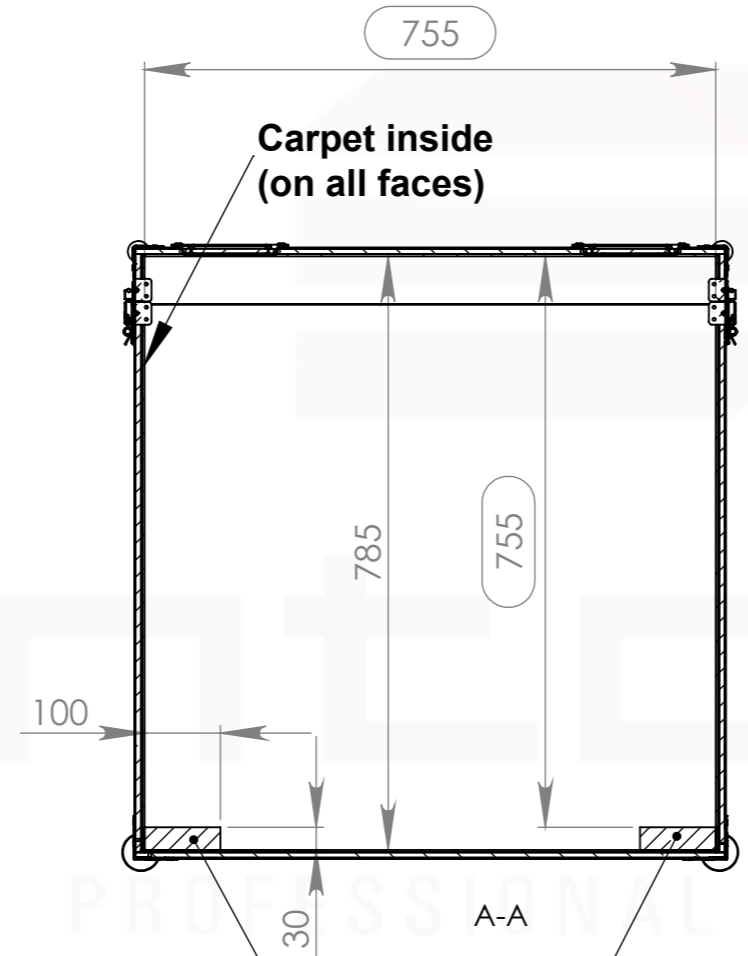

HD Foam

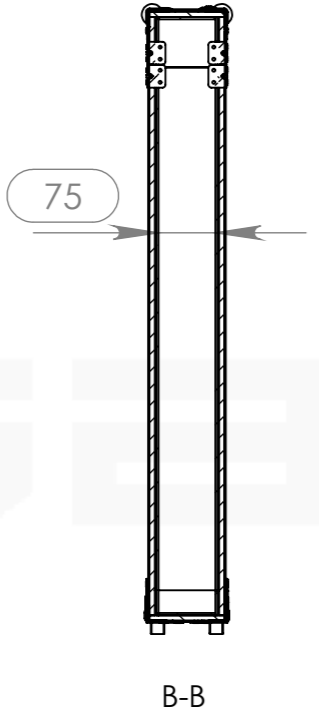
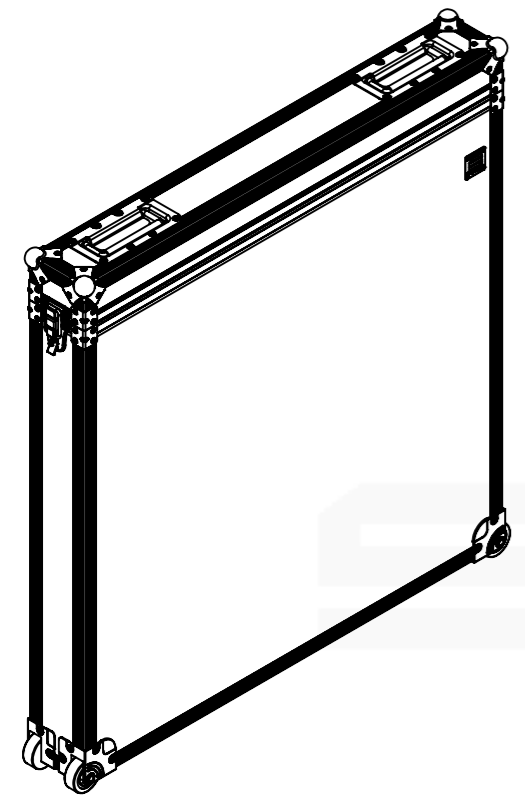
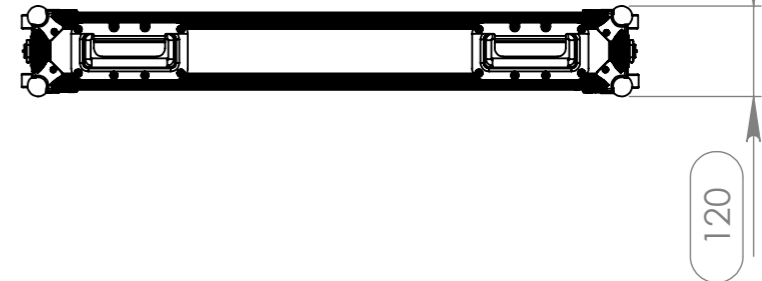
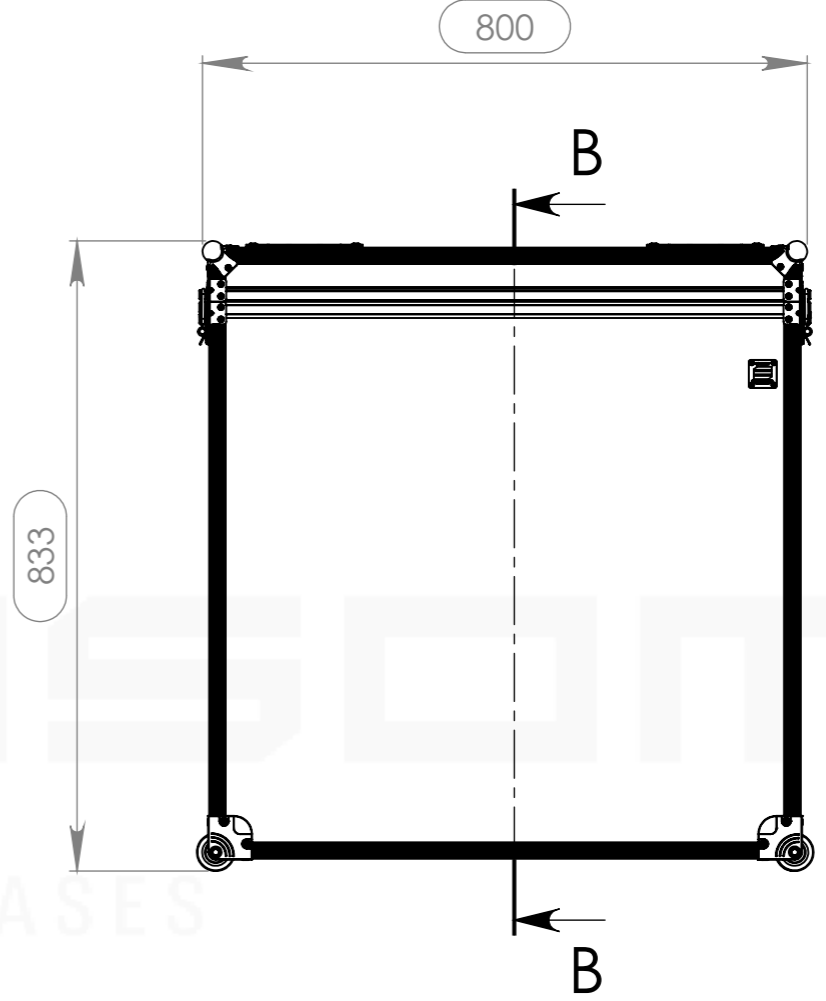

Hardware		
Qty	Ref.	Description
8	40407	Medium corner-brace zinc plated 1,0mm
4	4112	Small ball corner - 3 leg - zinc plated
4	W8255Z	Diecast corner castor with 50mm wheel
2	16021	Large padlocking drawbolt
2	340822	Recessed sprung handle - Small
1	CHAPA.1001	Identification Plate

This drawing must not be copied or disclosed without consent of the owner

Drawn by	alexandre	Date	12/08/2016
Reference	SCTP.0755R		
Scale	1:10	units in mm	general tolerance 0.8mm
1st Angle projection	FLIGHTCASE SC. 755X75X755MM RODAS		

