

Internal Dimensions		
Width	Depth	Height
713	223	366
Weight	Approx. 5 Kg	
Wall Thickness		7mm

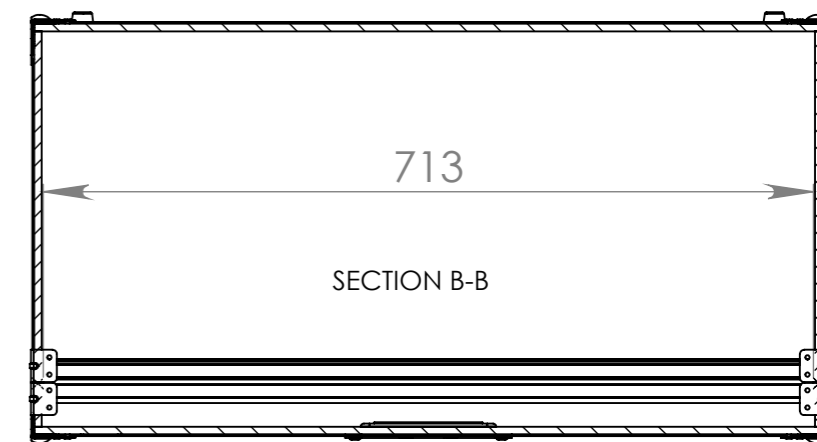
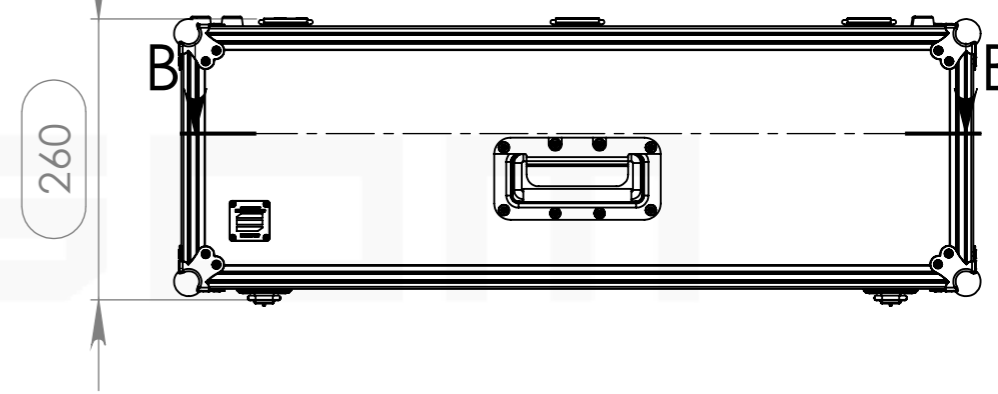
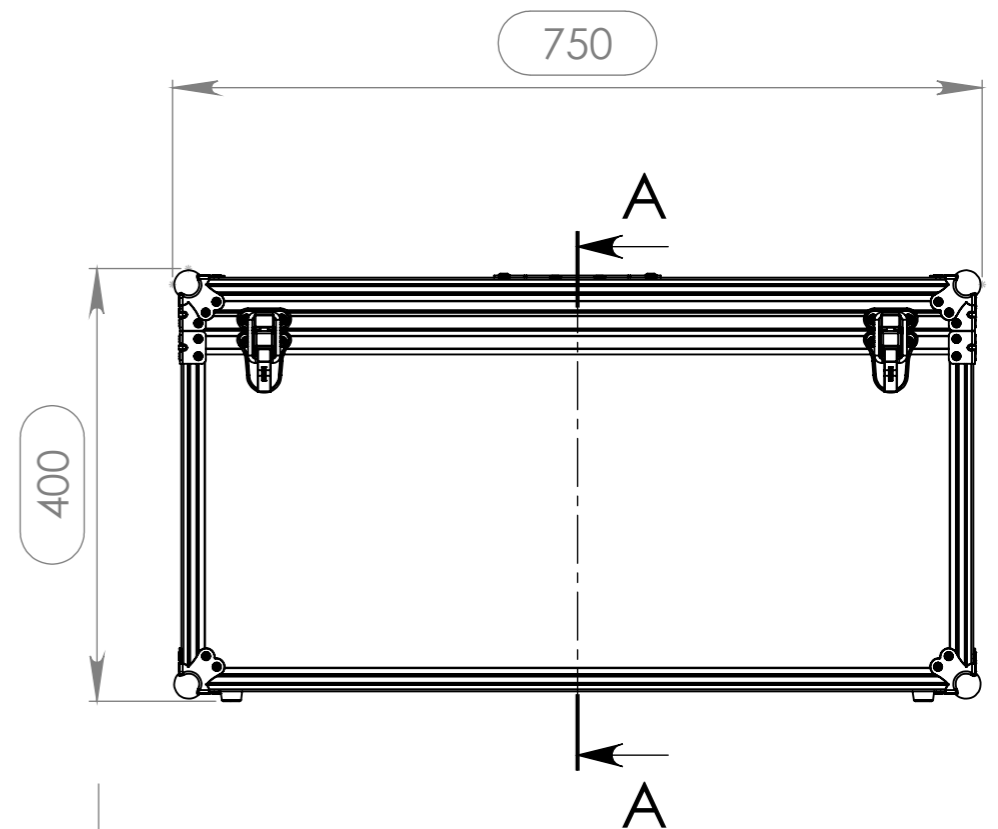
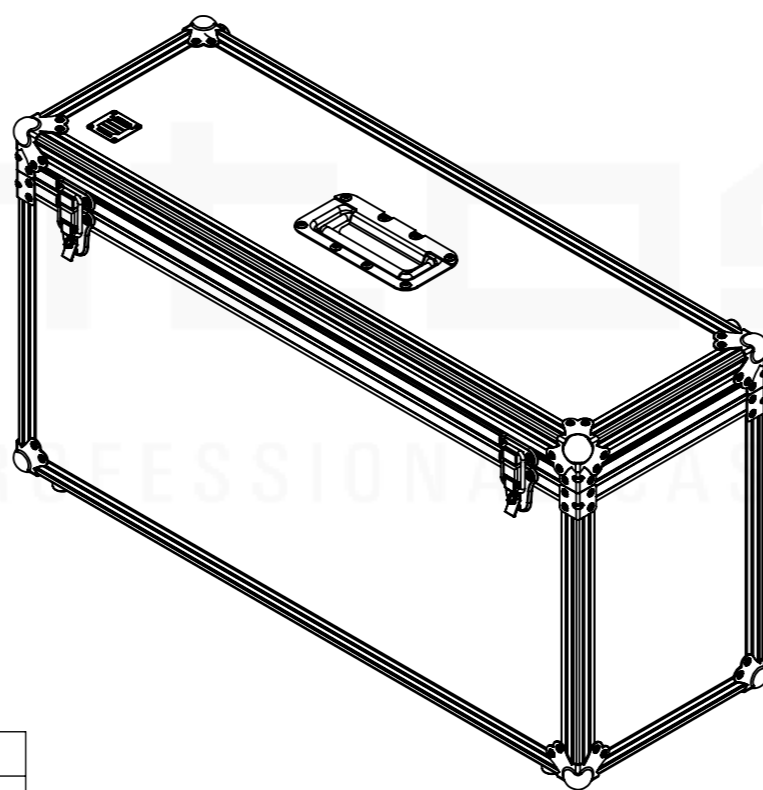
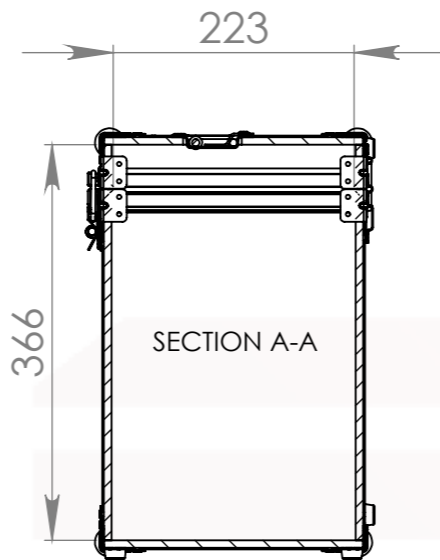
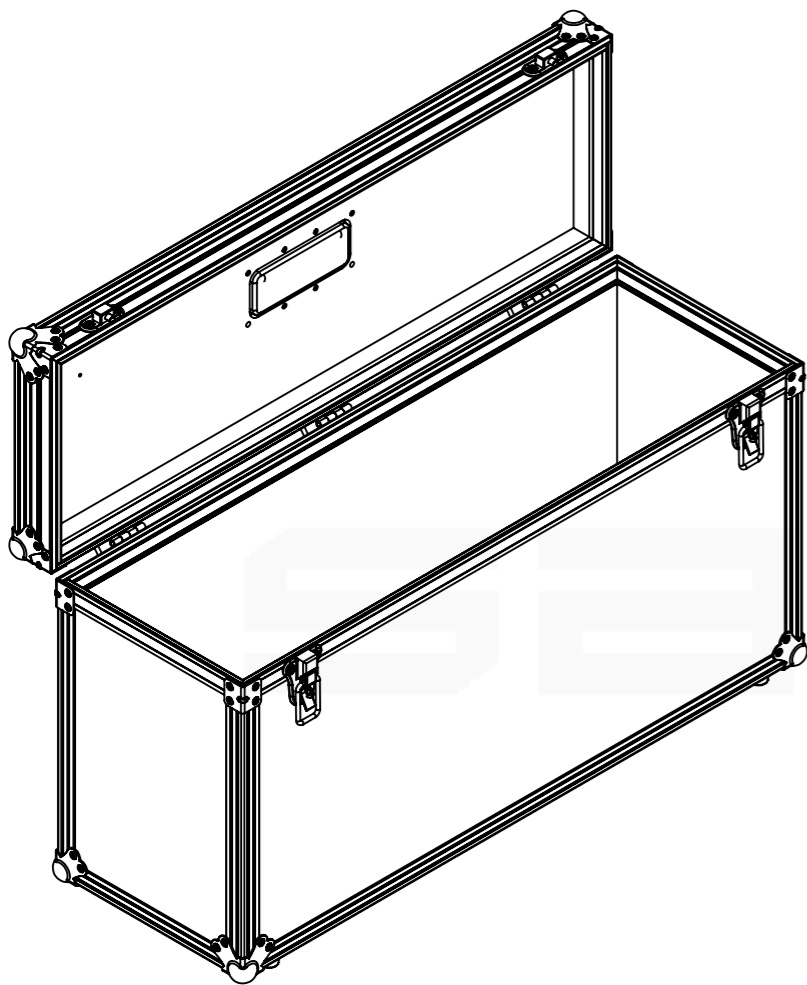

Hardware		
Qty	Ref.	Description
1	CHAPA.1001	Identification Plate
8	4903	Rubber foot 20 x 9 mm, black
4	40407	Medium corner-brace zinc plated 1,0mm
2	16021	Large padlocking drawbolt
3	2524	HEAVY DUTY STRUT HINGE WITH BLACK PLATE
4	40407	Medium corner-brace zinc plated 1,0mm
8	C1345Z	Small ball corner - 3 leg - zinc plated
1	340822	Recessed sprung handle - Small

This drawing must not be copied or disclosed without consent of the owner

Drawn by	Name	Date
projects		07/06/2017
Reference	S1AA.0752640	
Scale	units in mm	general tolerance
1:7	DO NOT SCALE	0.8mm
SMALLCASE S1 713X223X366 INTERIORES		

