

**BARRA DE 44 UN ( 1959,3 mm) P/ CORTAR**

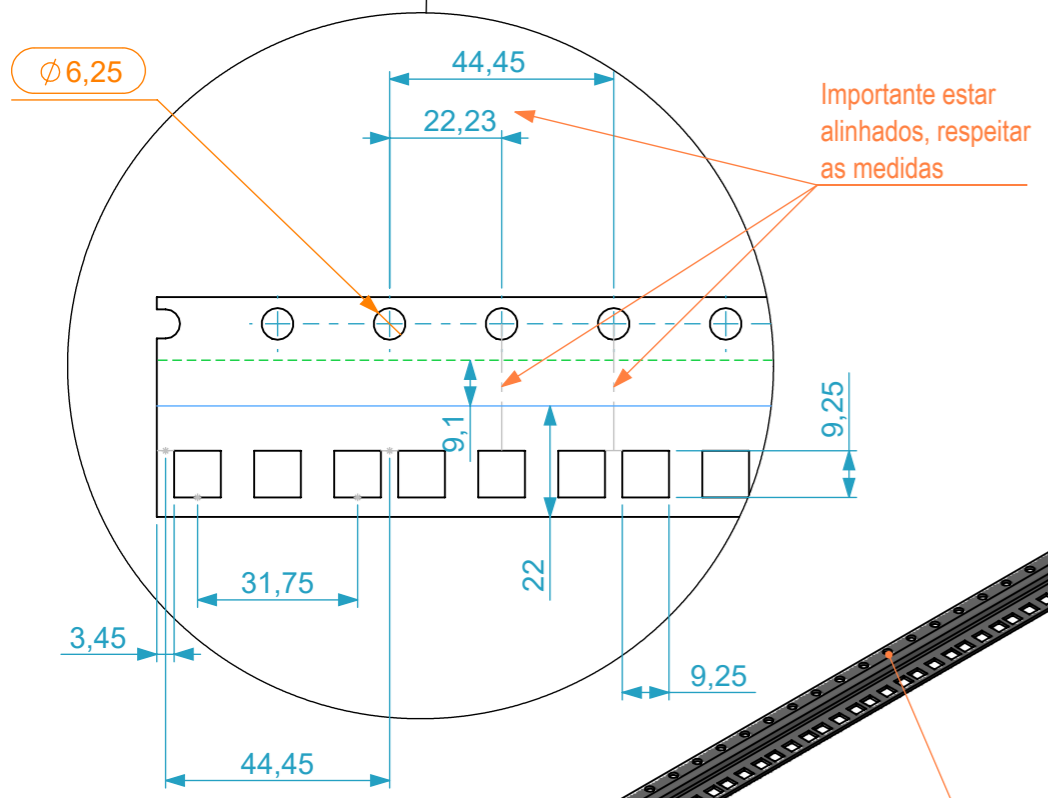

Importante estar alinhados, respeitar as medidas

**Material: Lacagem Preta**  
**Espessura: 2**  
**Planificado: 1959 x 44**  
**Furos: 219**  
**Quinagens: 2**  
**Peso: 79.047 kg**

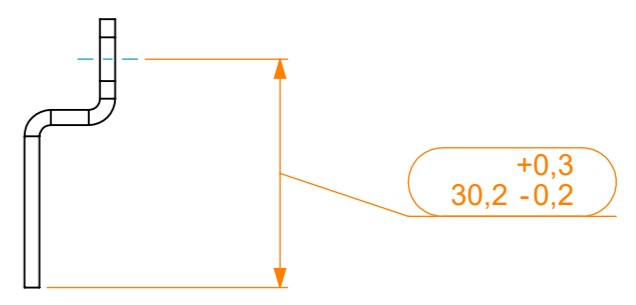

**ACABAMENTO:**  
**PINTURA ELECTROESTÁTICA**  
**EPÓXI-POLIÉSTER RAL 9005**  
**TEXTURADO FINO**

Material	Name	Date
Drawn by	paula.almeida	10/03/2023
Reference	PRUMO.1006A	
This drawing must not be copied or disclosed without consent of the owner	Scale	units in mm
	1:3	DO NOT SCALE
1st Angle projection	Prumo de Rack ferro 1/2 UN lateral, Barras de 2 mt - 14mm	

