

| Interior dimensions | | |
|---------------------|---------------|--------|
| Width | Depth | Height |
| 1250 | 200 | 740 |
| Weight | Approx. 50 Kg | |
| Wall Thickness | 10mm | |

| REVISIONS | | | | |
|-----------|------|---------------|------------|------------------|
| ZONE | REV. | DESCRIPTION | DATE | APPROVED |
| | 0 | Final Drawing | 15/06/2016 | Carlos Rodrigues |

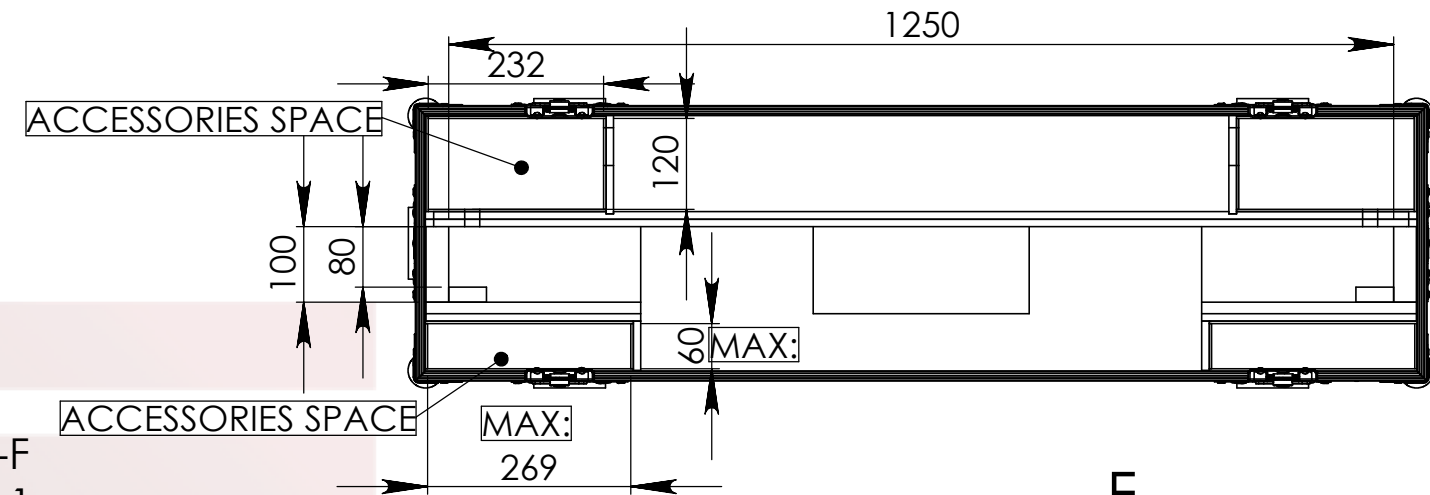

SECTION F-F
SCALE 1 : 11

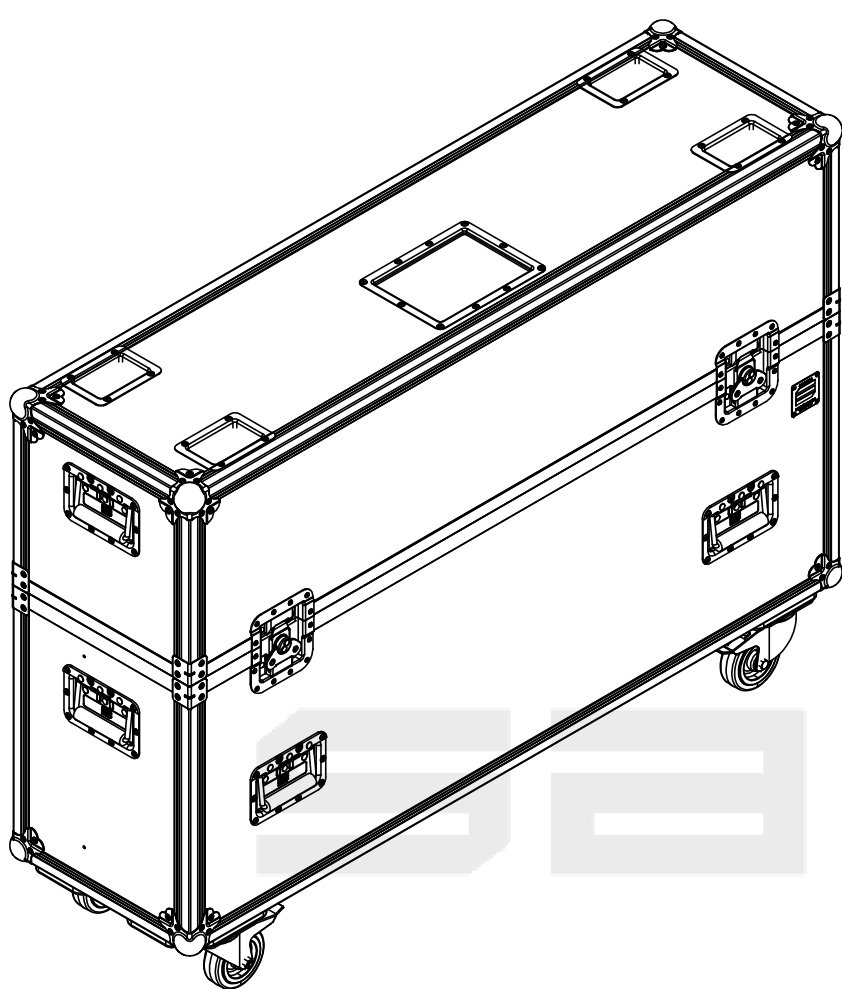
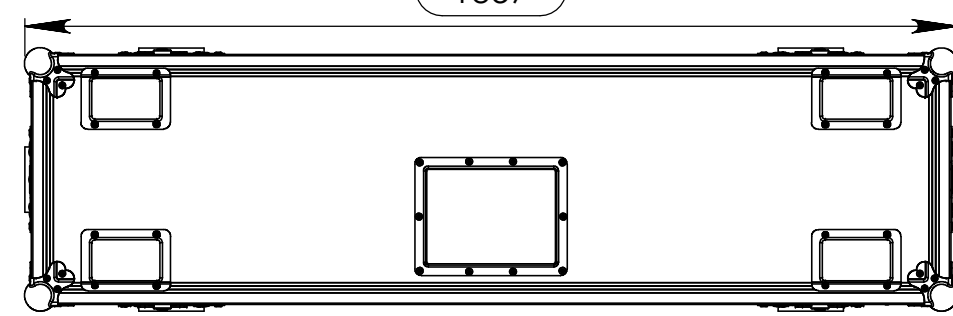
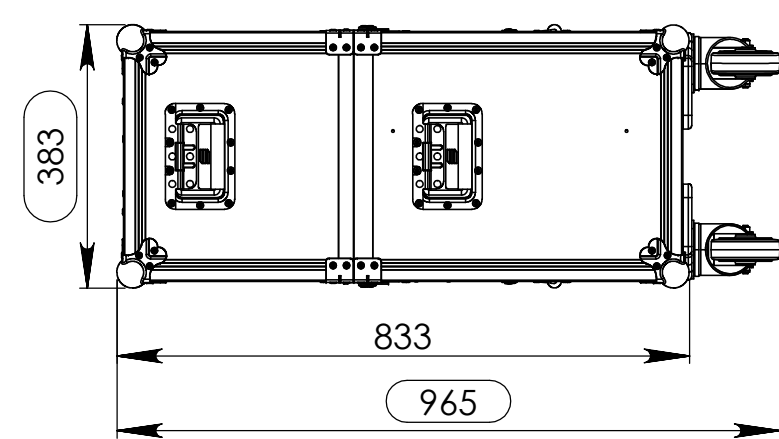
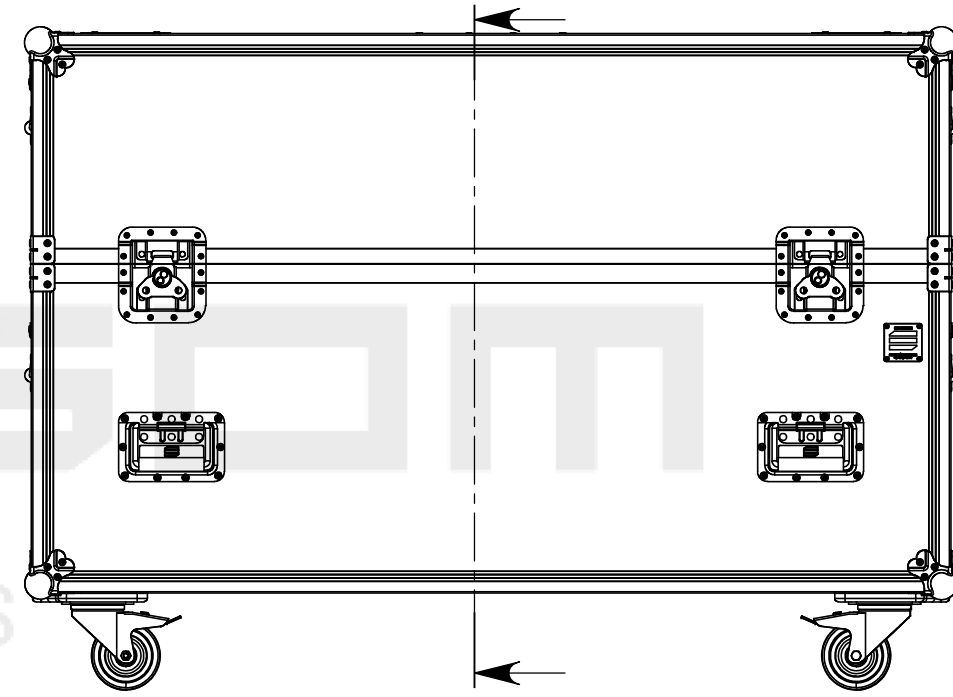
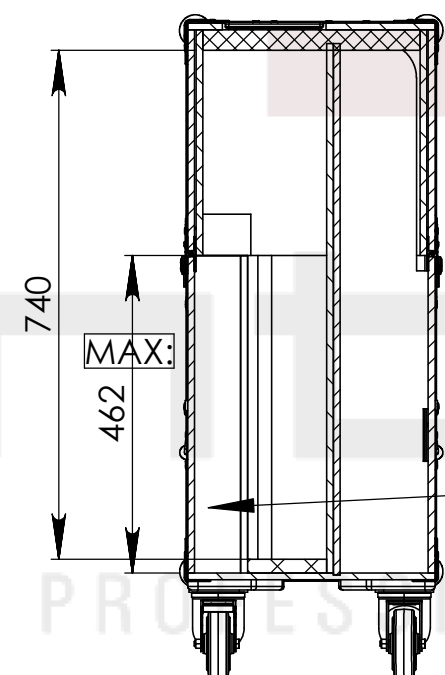

| Hardware | | |
|----------|------------|--|
| Qty | Ref. | Description |
| 8 | 410429 | Heavy Duty Ball Corner |
| 8 | 40403 | Large corner bracket f. 35mm case angle |
| 4 | 172531 | Large butterfly V3 with 'push-back' function |
| 8 | 34082 | Recessed sprung handle medium model |
| 1 | 88001D | Dish for 88001 Tour Label |
| 1 | CHAPA.1000 | Identification Plate |
| 2 | RODA.100T | Swivel castor Ø100mm with brake |
| 2 | RODA.100 | Swivel castor Ø100 mm |
| 4 | 38082 | Castor dish deep zinc plated |

This drawing must not be copied or disclosed without consent of the owner

| | | |
|--|--------------|-------------------|
| Drawn by | Name | Date |
| projects | | 17/06/2016 |
| Reference | PLASB1.050 | |
| Scale | units in mm | general tolerance |
| 1:5 | DO NOT SCALE | 0.8mm |
| FLIGHTCASE, LCD 50" MAX: 1250X150X740MM | | |

