

Internal Dimensions		
Width	Depth	Height
19"	490	30 U
Weight	Approx. 48 Kg	
Wall Thickness	10mm	

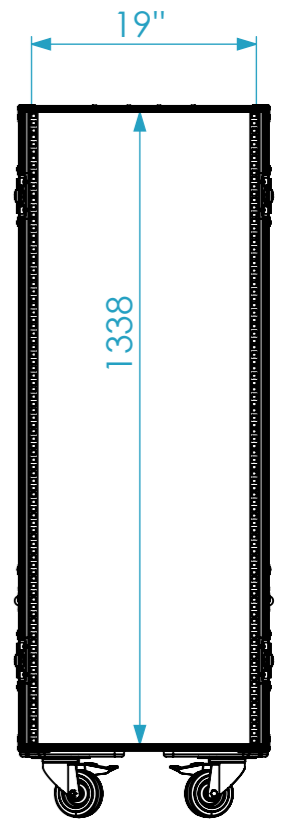

Hardware		
Qty	Ref.	Description
4	PRUMO.1005	Single Racks Strip 1/2U 2mm
16	40403	Large corner bracket f. 35mm case angle
1	CHAPA.1000	Identification Plate
2	RODA.100T	Swivel castor Ø100mm with brake
2	RODA.100	Swivel castor Ø100 mm
4	34082	Recessed Sprung Handle Medium
1	88001D	Dish for 88001 Tour Label
8	172531	Large butterfly V3 with 'push-back' function
4	87987	Insert for table connecting stud
4	87988	Spring loaded table mounting stud
4	0340.192	Stainless Steel Handle 192 mm
8	410429	Ball Corner large three-leg cranked 35 mm 9 holes

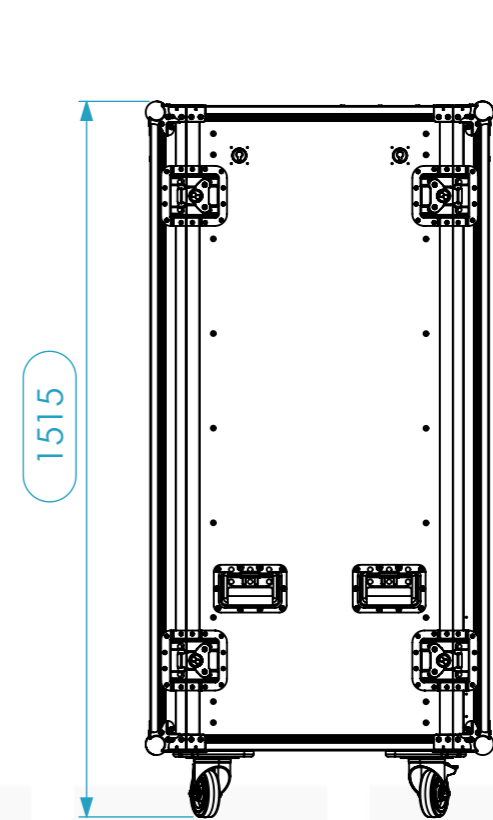
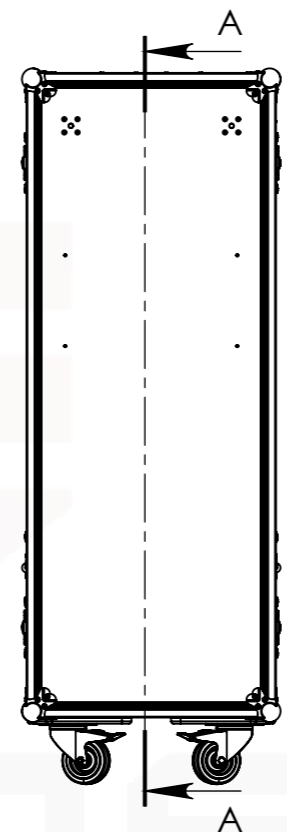
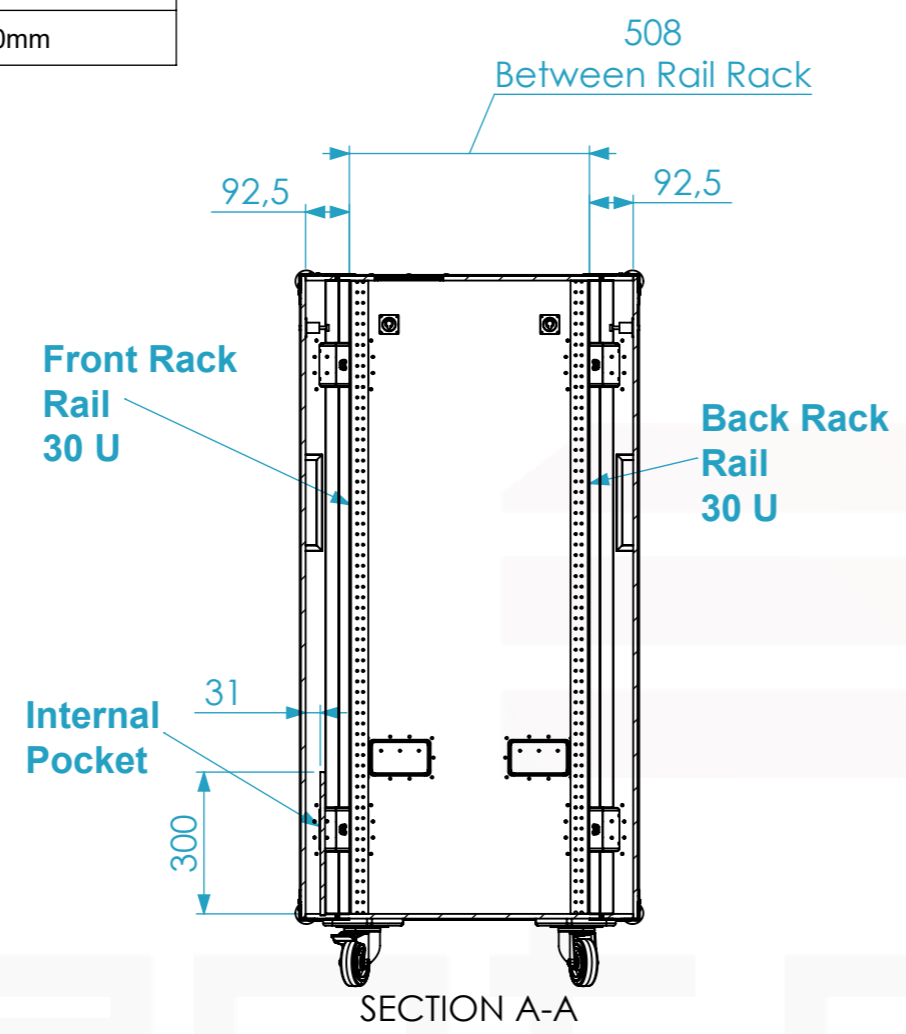
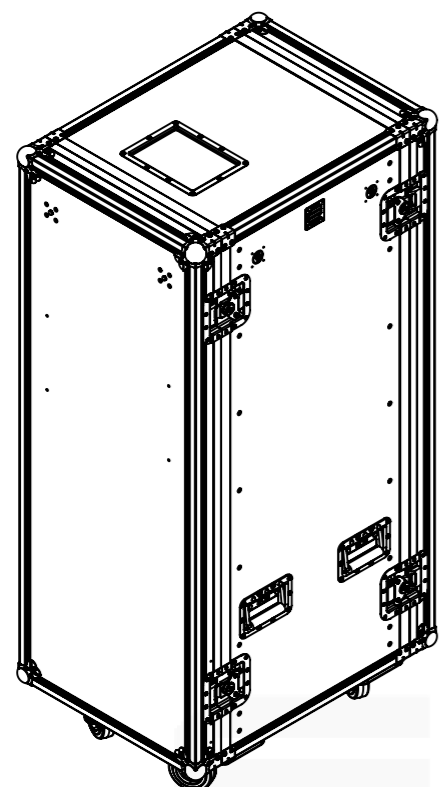
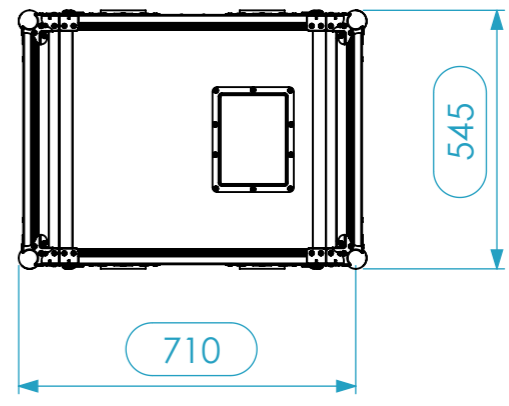
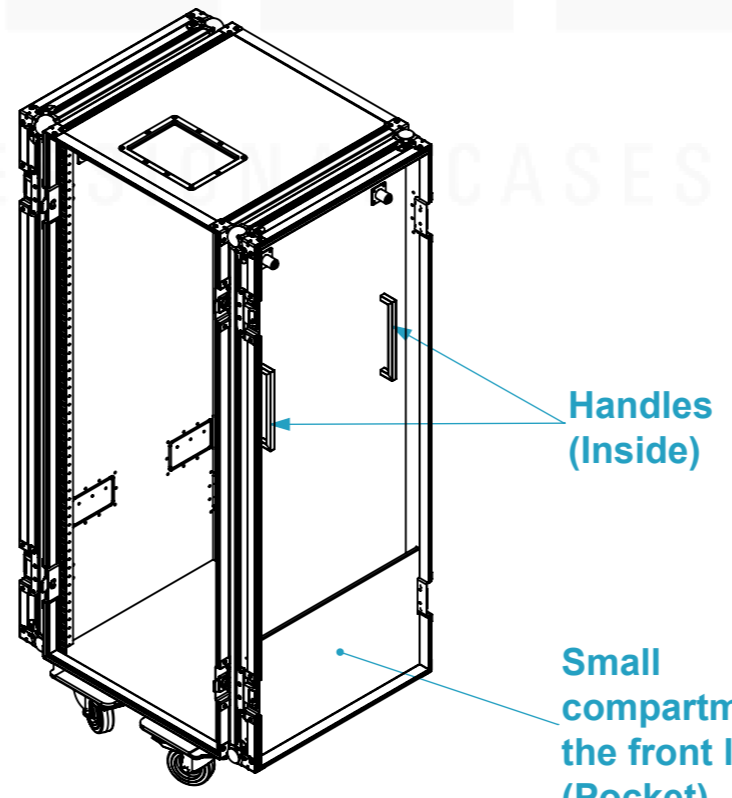

A3 This drawing must not be copied or disclosed without consent of the owner

Drawn by	Name	Date
alexandre	alexandre	19-09-2017
Reference	K2T.3055RA	
Scale	units in mm	general tolerance
1:16	DO NOT SCALE	0.8mm
1st Angle projection	RACK 19" 2 TAMPAS 30U 550 PROF., RODAS	



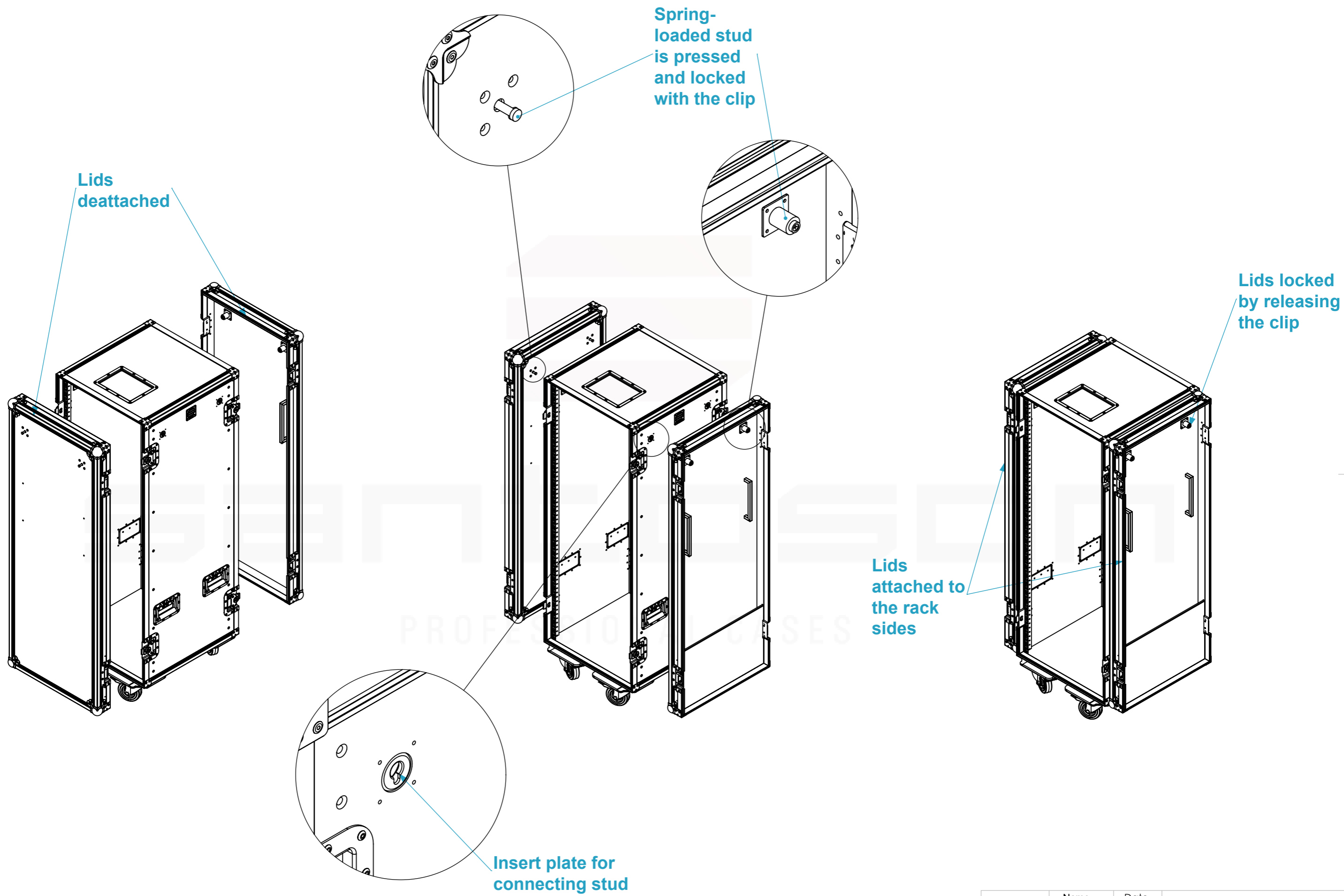

A3 This drawing must not be copied or disclosed without consent of the owner

Drawn by	alexandre	Date	19-09-2017
Reference	K2T.3055RA		
Scale	1:15	units in mm	general tolerance 0.8mm
1st Angle projection	DO NOT SCALE		
RACK 19" 2 TAMPAS 30U 550 PROF., RODAS			

