

Internal Dimensions		
Width	Depth	Height
513	363	223
Weight	Approx. 4 Kg	
Wall Thickness		4.5mm

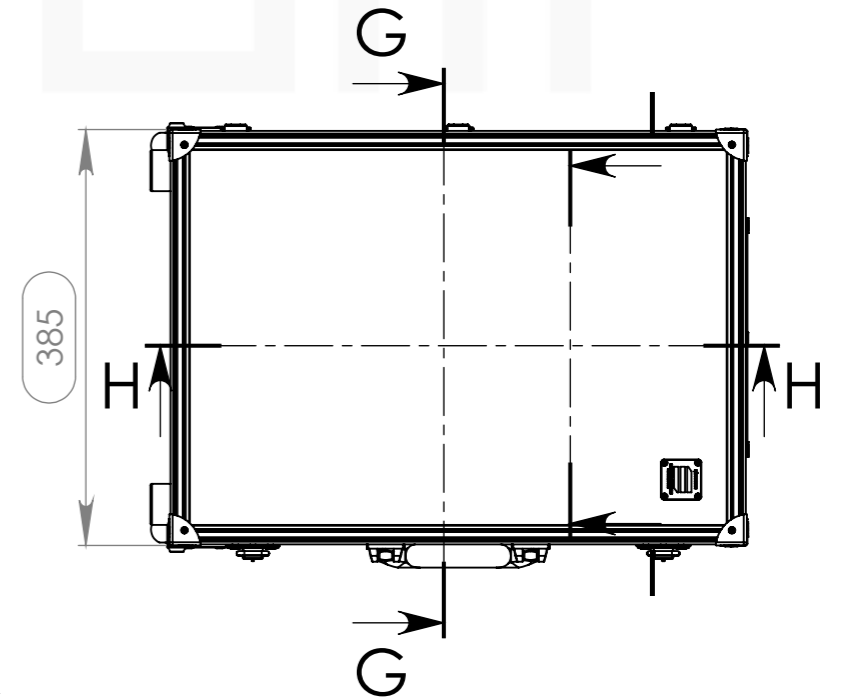
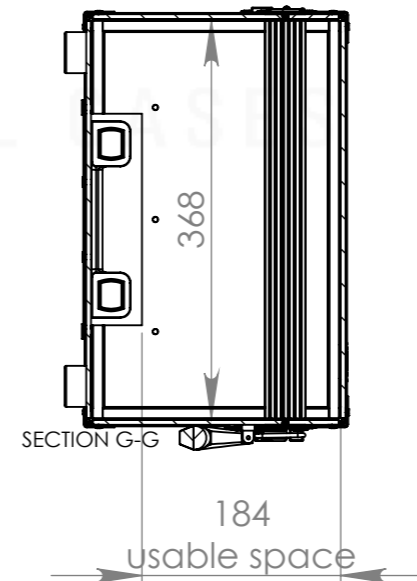
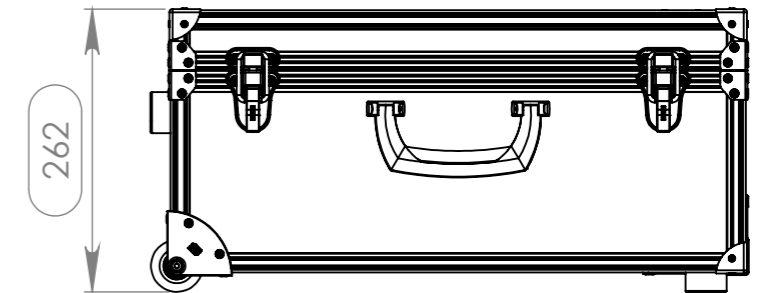
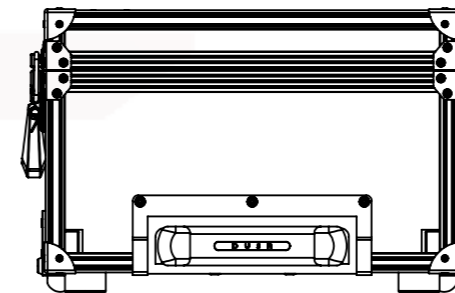
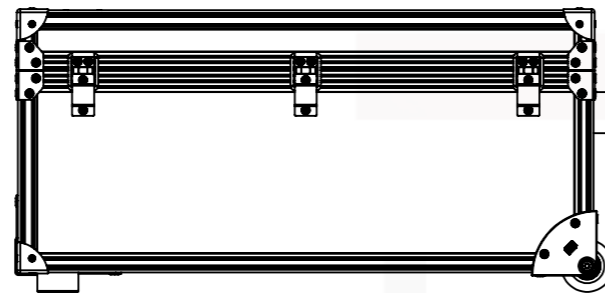
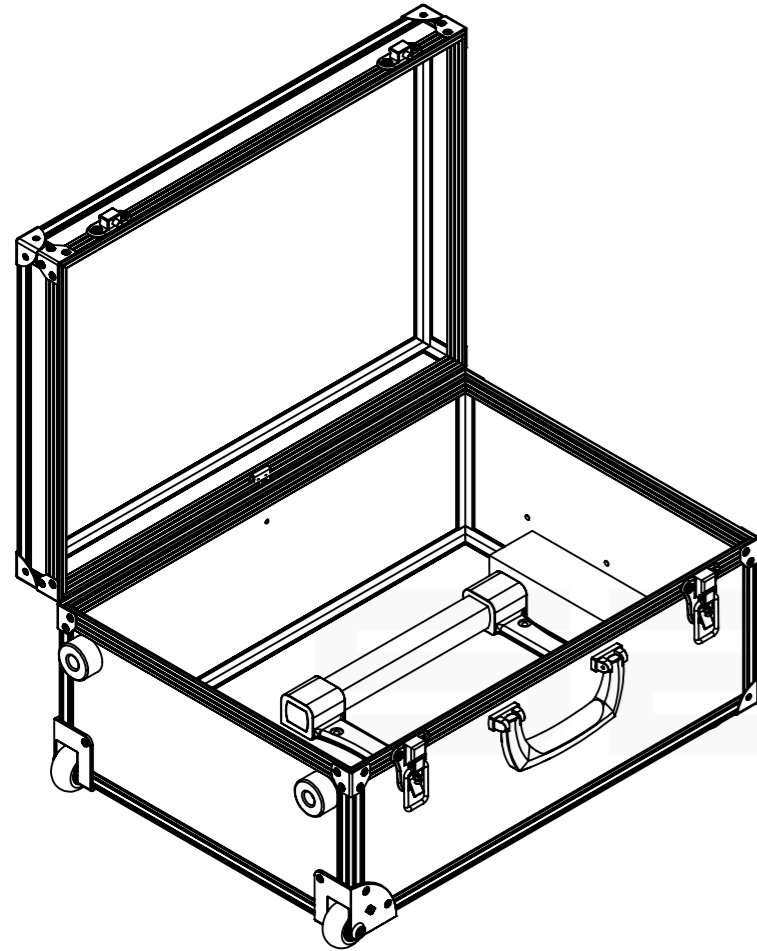
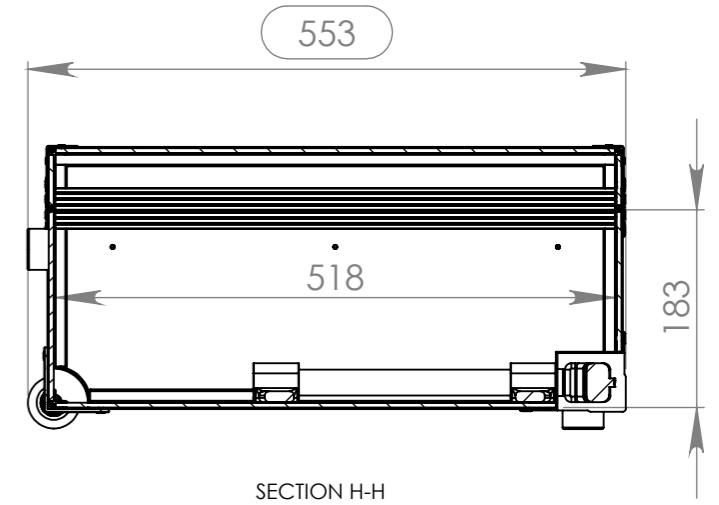
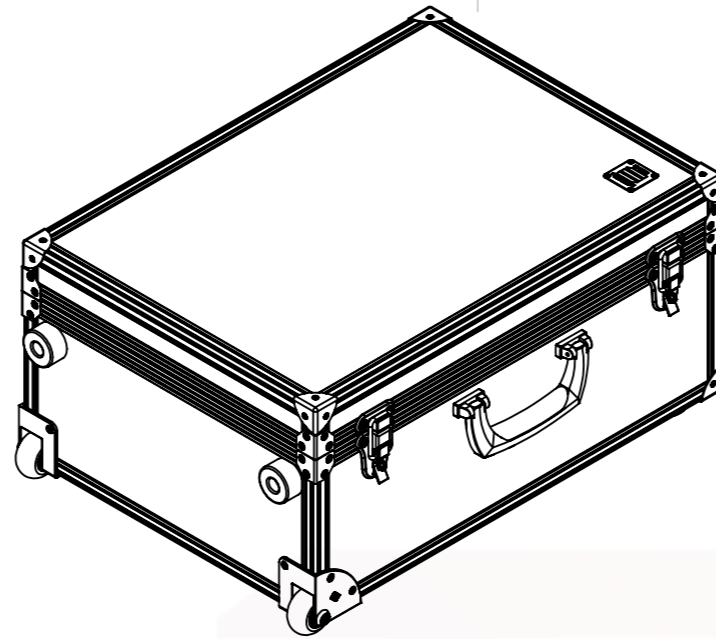

Qty	Ref.	Description
8	4046	Small corner brace - suits 6136 casemaker
1	3476041	Handle recessed extensible in three openings
1	H1432	Briefcase Handles - Matt Chrome with Black Grip
6	4008	Small case corner nickel plated
3	P1325.25	Small Strut Hinge, 25mm / 1"
1	CHAPA.1001	Identification Plate
2	16081	Large padlocking drawbolt
2	37600S	Castor with 48 mm wheel in aluminium
4	4909	38 mm rubber foot black with steel insert. Height: 20 mm.

This drawing must not be copied or disclosed without consent of the owner

Drawn by	Name	Date
projects		09/06/2017
Reference	B1AAR.0554026	
Scale	units in mm	general tolerance
1:7	DO NOT SCALE	0.8mm
SANTOSOM BRIEFCASE		



A3

